

GAS MASS FLOW METERS

Flow Range Up to 1000 L/min, Pressures Up to 1000 psi, NIST Traceable

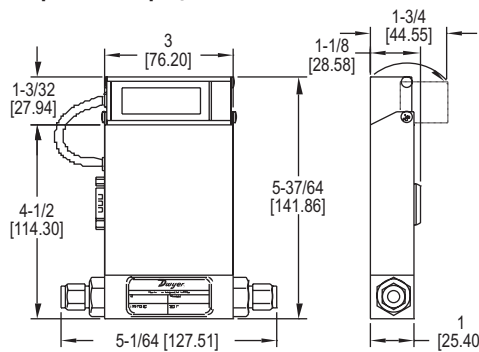

Model GFM-1101 thru GFM-1111 & GFM-2101 thru GFM-2111

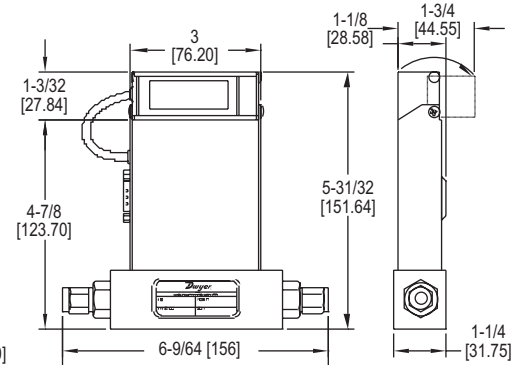

Model GFM-1140 thru GFM-1142 & GFM-2140 thru GFM-2142
Model GFM-1130 thru GFM-1133 & GFM-2130 thru GFM-2133

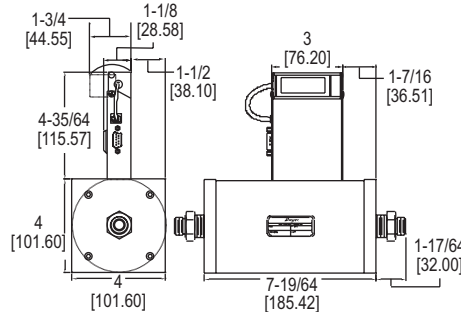

Model GFM-1143 thru GFM-1145 & GFM-2143 thru GFM-2145

Series GFM Gas Mass Flow Meters combine a straight tube sensor with a restrictor flow element to provide high accuracy and repeatability. Flow rates are virtually unaffected by temperature and pressure variations. Actual gas flow is displayed in engineering units on a 3-digit, 90° tiltable LCD readout. Units can be used with Series GFT Flow Totalizer for applications requiring totalization. Series GFM includes a NIST traceable certificate.

SPECIFICATIONS

Service: Clean gases compatible with wetted parts.
Wetted Materials: GFM-1XXX: Anodized aluminum, brass, 316 SS and fluoroeelastomer O-rings; GFM-2XXX: 316 SS and fluoroeelastomer O-rings.
Accuracy: ±1% FS including linearity over 59 to 77°F (5 to 25°C) and 5 to 60 psia (0.34 to 4 bar); Series X143, X144, X145, ±1.5% FS.
Repeatability: ±0.25% of FS.
Response Time: 2 s to within ±2% of actual flow.
Output: Linear 0-5 VDC and 4-20 mA.
Max. Particulate Size: 5 microns.
Temperature Limits: 32 to 122°F (0 to 50°C).
Power Supply: ±12 VDC.
Process Connections: 1/4" compression fitting for flow rates ≤50 L/m; 3/8" for 100 and 200 L/m; 1/2" for 500 L/min; 3/4" for 1000 L/min.
Pressure Limits: 1000 psig (68.9 bar); Series GFM-X143, X144, X145, 500 psig (34.5 bar).
Leak Integrity: 1 x 10⁻⁹ sccs of He.
Display: 90° tiltable, 3-1/2 digit.
Agency Approvals: CE.

ACCESSORIES

Model	Description
GFM-110P	110 V power supply
GFM-220PE	220 V power supply
GFM-CBL4	3' cable for 4-20 mA output
GFM-CBL5	3' cable for 0-5 VDC output

MODEL CHART

Model*	Material	Flow Range	Process Connector Compression Fitting	Model*	Material	Flow Range	Process Connector Compression Fitting
GFM-1101	Aluminum	0 to 10 mL/m	1/4"	GFM-2101	SS	0 to 10 mL/m	1/4"
GFM-1102	Aluminum	0 to 20 mL/m	1/4"	GFM-2102	SS	0 to 20 mL/m	1/4"
GFM-1103	Aluminum	0 to 50 mL/m	1/4"	GFM-2103	SS	0 to 50 mL/m	1/4"
GFM-1104	Aluminum	0 to 100 mL/m	1/4"	GFM-2104	SS	0 to 100 mL/m	1/4"
GFM-1105	Aluminum	0 to 200 mL/m	1/4"	GFM-2105	SS	0 to 200 mL/m	1/4"
GFM-1106	Aluminum	0 to 500 mL/m	1/4"	GFM-2106	SS	0 to 500 mL/m	1/4"
GFM-1107	Aluminum	0 to 1000 mL/m	1/4"	GFM-2107	SS	0 to 1000 mL/m	1/4"
GFM-1108	Aluminum	0 to 2 L/min	1/4"	GFM-2108	SS	0 to 2 L/min	1/4"
GFM-1109	Aluminum	0 to 5 L/min	1/4"	GFM-2109	SS	0 to 5 L/min	1/4"
GFM-1111	Aluminum	0 to 15 L/min	1/4"	GFM-2111	SS	0 to 15 L/min	1/4"
GFM-1131	Aluminum	0 to 30 L/min	1/4"	GFM-2131	SS	0 to 30 L/min	1/4"
GFM-1133	Aluminum	0 to 50 L/min	1/4"	GFM-2133	SS	0 to 50 L/min	1/4"
GFM-1142	Aluminum	0 to 100 L/min	3/8"	GFM-2142	SS	0 to 100 L/min	3/8"
GFM-1144	Aluminum	0 to 200 L/min	3/8"	GFM-2143	SS	0 to 200 L/min	3/8"
GFM-1144	Aluminum	0 to 500 L/min	1/2"	GFM-2144	SS	0 to 500 L/min	1/2"
GFM-1145	Aluminum	0 to 1000 L/min	3/4"	GFM-2145	SS	0 to 1000 L/min	3/4"

*Specified flow ranges are for an equivalent flow of nitrogen at 70°F (21°C) @ 760 mm Hg.

USA: California Proposition 65
 ⚠WARNING: Cancer and Reproductive Harm - www.P65Warnings.ca.gov